

Bituminous Macadam

New Layer of WBM
(150 mm thick)

Surface finishing.

Prime Coat

Existing WBM

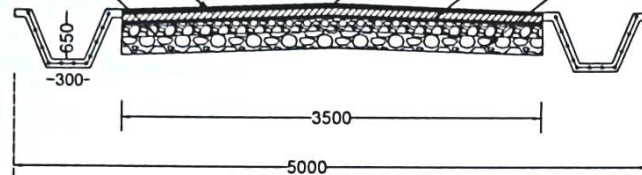

Road cross Section at End

Bituminous Macadam

New Layer of WBM
(150 mm thick)

Surface finishing.

Prime Coat

Existing WBM

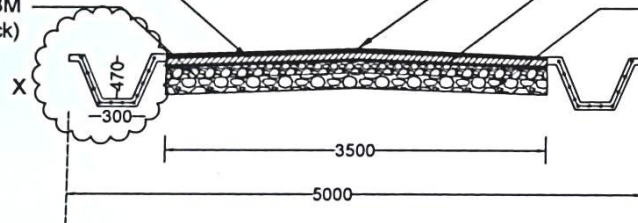

Road cross Section at Mid

Bituminous Macadam

New Layer of WBM
(150 mm thick)

Surface finishing.

Prime Coat

Existing WBM

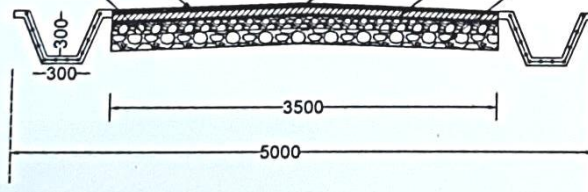

Road cross Section at Starting

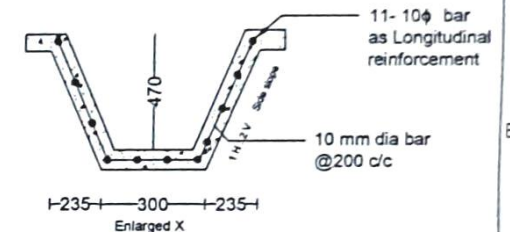

All dimensions are in mm
Maintain a Longitudinal slope of 1 in 1000

DATE	FIRST SUBMISSION	DESCRIPTION
Client Name : ASSAM ELECTRICITY GRID CORPORATION LIMITED		
Drawing Kind : Drawing For Approval.	Title : Proposed Switchyard Bituminous Road cross section with side drain at 220 kV Agia GSS, AEGCL, Agia.	Paper Size A3
Work order No. :		Scale NTS
Page 01/01	Contractor Name :	

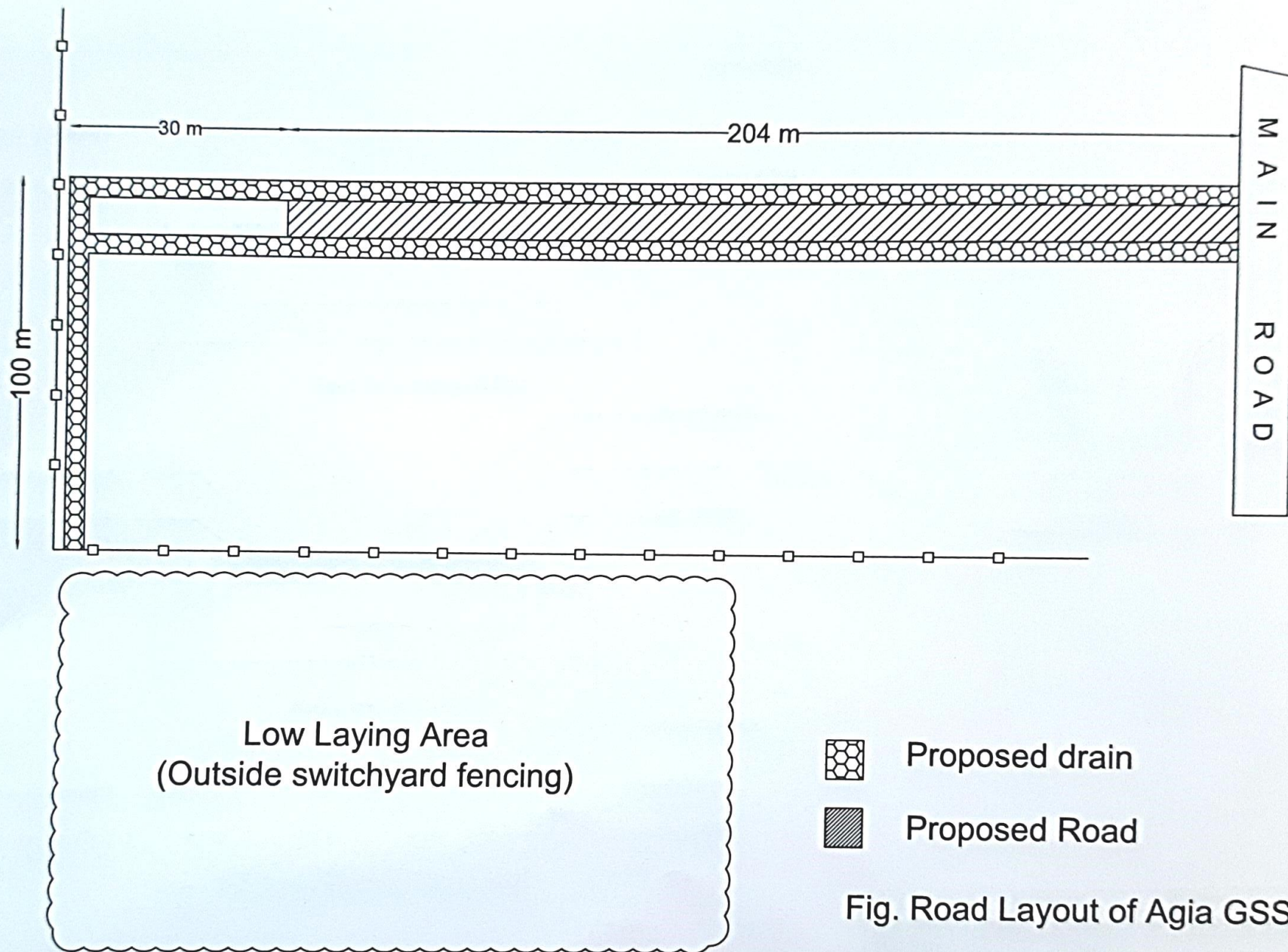

Fig. Road Layout of Agia GSS