

Repairing/renovation of Officer's Hostel at 132KV GSS Rupai, AEGCL.

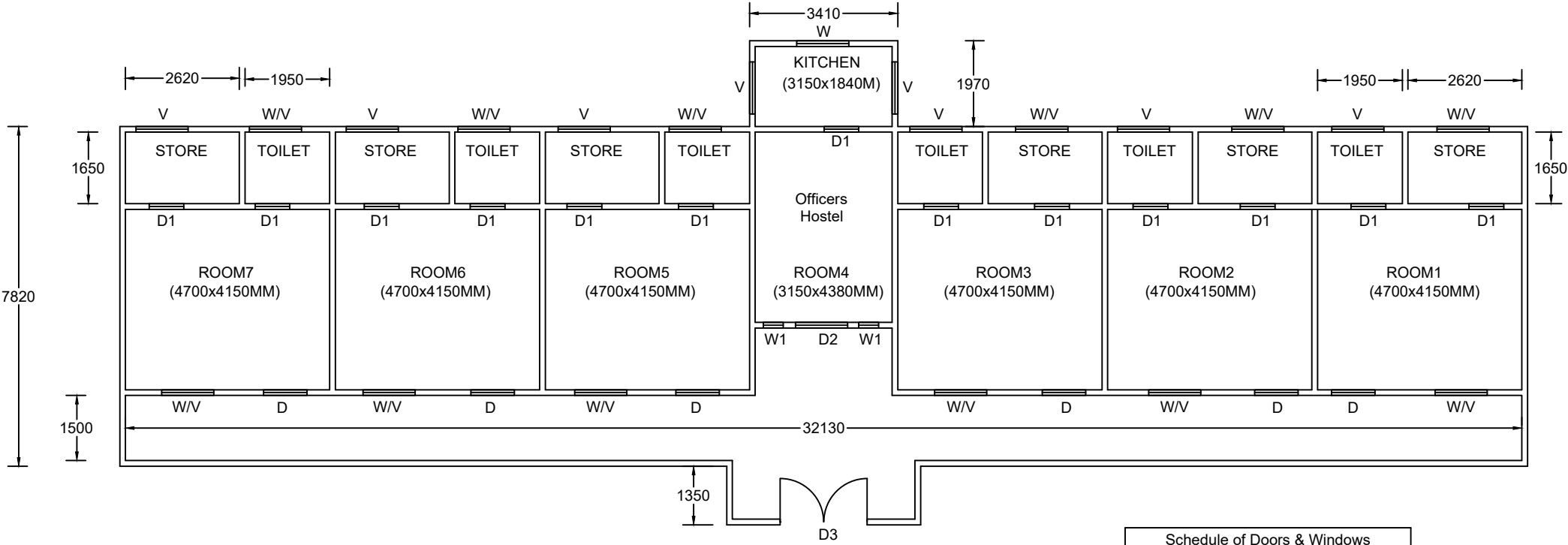

All Dimensions are in MM

Schedule of Doors & Windows			
Sl. No.	Marked	Size	No.
1	D	1.00x1.95M	6
2	D1	0.80x1.90M	13
3	D2	1.20x2.00M	1
4	D3	2.00x2.00M	1
5	W	1.20x1.20M	13
6	W1	0.46x1.20M	2
7	V	1.20x0.45M	20